

ARCTIC FOX

GRANDE RONDE

32-5M

www.northwoodmfg.com

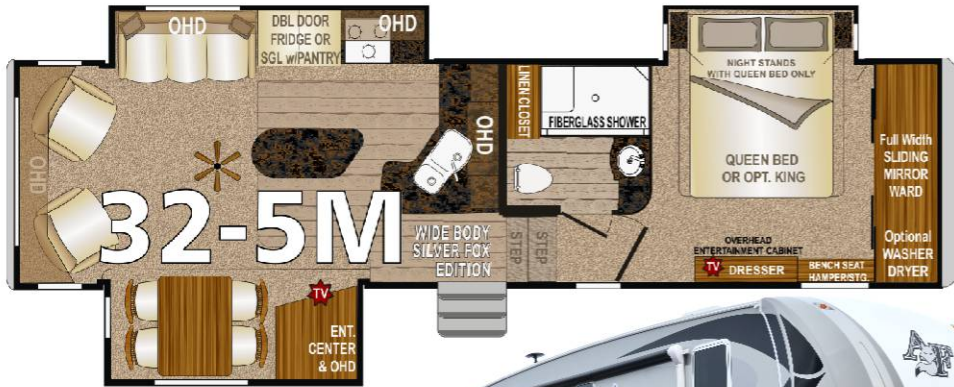

Specifications

- | | |
|--------|--|
| 32-5M | Model Number |
| 10122 | Dry Axle Weight (approx. Lbs.) |
| 2778 | Dry Hitch Weight (approx. Lbs.) |
| 3100 | Net Carrying Capacity |
| 12900 | Gross Dry Weight-lbs (approx. Lbs.) |
| 16000 | Gross Vehicle Weight Rating (GVWR)-Lbs. |
| 36'10" | Exterior Length (approx. w/hitch) |
| 13'3" | Exterior Height (approx. incl. AC unit) |
| 8'6" | Exterior Width (approx. w/o awning) |
| LT235 | Tire Size |
| 85R16 | |
| G | Load Range |
| 82 | Fresh Water w/ Water Heater (approx. gal.) |
| 67 | Gray Water Tank (approx. gal.) |
| 65 | Black Water Tank (approx. gal.) |
| 20 | LPG Capacity (approx. gal.) |
| YES | CSA - Canadian Dealers Only |
| 35 | Auto Ignition Furnace (1,000 BTU's) |



ARCTIC FOX 32-5M

Standard Features

- Northwood Built, Independently Certified, Off-Road Chassis
- Fully Welded, Thick-Wall Aluminum Frame Construction
- One-Piece, Corona Treated, Continuous Fiberglass
- Hot, Polyurethane Laminated, Multi-Layered Substrate Walls
- High Density Block Foam Insulation
- Wide-Body Floorplan/MORyde Step Above w/Strut Assist
- E-Z Lube Axles w/Neve-R Adjust Forward, Self Adjusting Brakes
- Heavy Duty Greaseable Suspension
- 16" Aluminum Wheels / Tires & White Mod Spare
- MORyde RPB Pin Box / 6 Point Leveling System
- Bed Slide / Dinette Slide/ Flush Floor Super Slide
- All-Conditions/Four Seasons Insulation With R-18 Ceiling
- R-15 Reflective Foil Insulation in Roof / Slides
- Heated Holding Tanks / Cathedral Arched Ceiling
- Aerodynamic One Piece Front Cap
- 2 Independently Switched LED Hitch Lights
- Fiberglass Rear Cap / LED Cap Accent Lights
- LED Interior & Exterior Lighting
- Roof Rack & Ladder / 20 Watt Solar Panel
- Exterior Convenience Center / Sidewall Solar Port
- SLAM Latch Luggage Doors / Magnetic Lugg Door Catches
- Black Water Flush System
- Large Exterior Entry Grab Handle / Entry Door Friction Hinge
- Exterior Shower / 2 Afox Logo Director's Chairs
- Semi-Automatic Winterization/By-Pass System
- 16 Gal DSI Gas/Elect Quick Recovery Water Heater
- 15m BTU Air Conditioner w/Condensation-Resistant Ducting
- Carefree Travel'R 12V LED Awning w/Adjustable Pitch HW
- 12v Power Land. Gear/Omni-Directional TV Antenna
- Outside Speakers/Battery Disconnect
- Thermal Pane Windows / Exterior Security Lights
- Generator Ready / Satellite Ready / Solar Ready
- Electric Power Reel / Digital Thermostat/50 Amp Service
- Interior Command Center / Afox Signature Throw Blanket
- Livingroom & Bedroom Carpet w/ Pad
- Roller Bearing Drawer Glides
- Fabric Night Shade Window Treatments
- 40" 110 LED Smart TV & AM/FM/CD/DVD Player w/Bluetooth
- Smoke, LPG & CO Leak Detectors / Charge Wizard
- Free-Standing Table With 4 Chairs
- 2 Cross-Stitch Swivel Rocker-Recliners
- Tri-Fold Sofa With Decorative Throw Pillows
- Solid Surface Kitchen Countertops / Furrion Cooking Suite
- 1.5 Cu Ft Over-The-Range, Convection Micro w/Range Hood
- Extra Large Fridge (10 Cu Ft) w/ Multiple Raised Panels
- Lighted Toe Kick / Arctic Fox Signature Clock & Entry Mat
- Daylitter Kitchen Skylight w/ Shade / Ceiling Fan
- FanTastic Vent w/Remote/Tstat/Rain Sensor (Kitchen)
- Solid Surface Bathroom Countertops w/SS Sink
- Exhaust Only Fan Vent - Bathroom
- Porcelain, Foot-Pedal Toilet / Bath Skylight
- Garden Shower / Glass Enclosure / Bathroom Courtesy Light
- Telescoping Lighted Vanity Mirror / Lock Box
- NW TruRest Mattress w/UltraDeck Sleep System
- FanTastic Vent w/Remote/Tstat/Rain Sen (Bedroom)
- Hardwood Dresser Top / Bedroom Starlite w/ Shade
- USB Charging Ports on Both Sides of Bed

Other Available Options

- 29" Surround-Soundbar
- Slide Tray in Pass Thru
- Kitchen Slide Topper
- Dinette Slide Topper
- Bedroom Slide Topper
- Alumaguard Main Awning
- CSA (Canadian Dealers Only)
- 32" 110V LED Smart TV Bedroom
- 15K Low Pro Air Conditioner w/Ducting
- 2nd A/C (Low Pro 13.5K) - Replaces Bdrm Fan Vent
- Slow Rise Night Shades
- Holding Tank Heat Pads (All Tanks)
- Exterior Entertainment Center
- Powered Sliding Stab Jacks, Rear
- Fireplace
- King Bed
- 5.5 Onan Gold LP Generator
- 100 Watt Solar Panel
- 170 Watt Solar Panel
- Washer/Dryer Combo
- Winegard Carryout G2+ Sat Dish (DISH/DIRECT)
- (HD Sat-Call For Options)
- Cross-Stitch Sofa 62"
- Rear View Camera
- 12 Cu Ft Fridge and Panels