



# ARCTIC FOX



# 992

www.northwoodmfg.com

## ARCTIC FOX 992

### Standard Features

Fully Welded, Thick-Wall Aluminum Frame Construction  
 One-Piece, Corona Treated, Continuous Fiberglass  
 Hot, Polyurethane Laminated, Multi-Layered Substrate Walls  
 All-Conditions/Four Seasons Foam Block Insulation  
 Cathedral Arched Ceiling  
 Dinette Slide  
 Heated Holding Tanks  
 Deluxe Bumper w/Hose Carrier  
 Residential Wear Floor Covering  
 LED Exterior Lighting / 45 Watt Solar Panel / Sidewall Solar Port  
 LPG Quick Connect / Black Water Flush System  
 Automatic Change-Over Regulator  
 Exterior Shower / Entry Door Friction Hinge  
 6 Gal DSI Gas/Elect Quick Recovery Water Heater  
 20K BTU Auto Ignition Furnace w/Digital Thermostat  
 Marine Style Detachable Shore Cord  
 12-Volt Disconnect Switch  
 Frameless Windows  
 Rear Back-Up Window  
 Generator Ready / Satellite Ready / Solar Ready  
 Magnetic Luggage Door Catches  
 LED Interior Utility & Decorative Lighting  
 Interior Command Center  
 Custom One Piece Formed Countertops & Dinette Table  
 Ozite Ceiling Carpet Front To Back  
 Designer Wood Grain Finish Throughout  
 Roller Bearing Drawer Glides / Hidden Hinges on Cabinet Doors  
 Fabric Night Shade Window Treatments  
 AM/FM/CD/DVD Player w/Bluetooth  
 Smoke, LPG & CO Leak Detectors  
 Charge Wizard  
 Stainless Steel Appliances  
 Residential, Built-In Microwave  
 High Output 3-Burner Range with Range Cover  
 Daylighter Kitchen Skylight w/ Shade  
 Porcelain, Foot-Pedal Toilet / Bath Skylight  
 Magnetic Shower Curtain w/Curved Track / Garden Shower  
 NW TruRest Queen Mattress w/ Bedspread  
 Privacy Curtin in Cab Over  
 USB Charging Ports on Both Sides of Bed

### FOX VALUE PACK #505: (MANDATORY)

Rear Electric Awning/Sliding Battery Rack  
 Dual 30lb LP Tanks/ Roof Rack & Ladder  
 Rieco Titan Electric Jacks w-6 function remote/Outside  
 Speakers / "Joey" Sliding Storage Tray/Omni-Directional TV Antenna  
 Extender Ready / Diamond Plate Knee Wall Armor  
 Large 2 Way Fridge (7 Cu Ft) w/ Cold Weather Kit  
 Deluxe Stainless-look Refrigerator Door Panels  
 Large 22" Oven/Microwave Oven  
 Multi-Speed Reversible Fan Vent  
 Hardwood Hamper Doors  
 Below Dinette Access Door & Drawer  
 Front Bedroom Shelf/Bedspread

### Other Available Options

Large Exterior Folding Grab Handle  
 CSA (Canadian Dealers Only)  
 28" 12v LED TV  
 Thermal-Pane Windows  
 Arctic Fox Camper Seat-Step  
 Fox Landing  
 Pull Out Mid Step  
 Addl. Fox Landing steps  
 2.5 Onan LP Generator  
 100 Watt Solar Panel  
 170 Watt Solar Panel  
 Winegard Carryout G2+ Sat Dish (DISH/DIRECT)  
 Overhead Bunk In Dinette  
 Swing Out Brackets  
 72" Roll-over Lounge  
 Full Wall Ward Curb Side  
 3-Way 7 cu ft Dbl Door Refer  
 11K BTU Air Conditioner  
 3 Burner Cooktop (Del Oven) - No Charge  
 Aussie Grill w/Bracket  
 Coleman Mach 8 9K BTU A/C  
 Convection Oven (Del Microwave)  
 2 Lg Drawers Under Cooktop  
 24" Add-A-Step  
 10' Side Box Awning  
 Slide Out Topper  
 Rear View Camera  
 Gateway Router  
 FOX VALUE PACKAGE

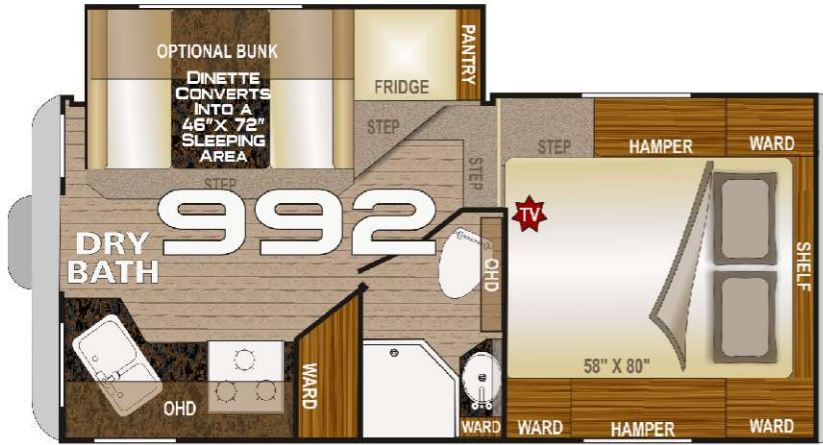

### Specifications

|              |                                     |
|--------------|-------------------------------------|
| 992          | Model Number                        |
| 3235         | Dry Weight Lbs.                     |
| 1467         | Dry Weight Kgs.                     |
| 8'1"         | Width                               |
| 8'7"-10'w/AC | Exterior Height                     |
| 6'7"         | Interior Height                     |
| 10'2"        | Floor Length                        |
| 17'10"       | Overall Length                      |
| 46           | Fresh Water w/Water Heater          |
| 39           | Gray Water                          |
| 37           | Black Water                         |
| 14           | LPG Capacity (approx. gallons)      |
| 20           | Auto Ignition Furnace ( 1000 BTU's) |

